

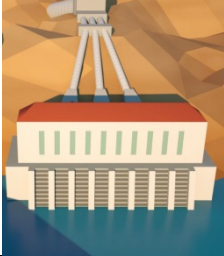

NAME _____

VIRTUAL TOUR OF THE COLORADO RIVER AQUEDUCT

1. What is the Colorado River Aqueduct? Describe its purpose. How long is it?

2. Use 1-2 sentences to describe each of the following locations in the virtual tour:

Location	Description
<p data-bbox="94 619 406 646">Parker Dam and Lake Havasu</p>  A 3D rendering of the Parker Dam, a large concrete dam with multiple spillways, situated in a desert landscape. The dam is surrounded by brown hills and a blue reservoir.	
<p data-bbox="94 980 324 1008">Intake Pumping Plant</p>  A 3D rendering of the Intake Pumping Plant, a large industrial building with a red roof and multiple intake pipes extending into the water.	
<p data-bbox="94 1270 414 1297">Iron Mountain Pumping Plant</p>  A 3D rendering of the Iron Mountain Pumping Plant, a large industrial building with a red roof, situated on a hillside. A blue pipe runs up the hill to the plant, and another pipe runs down to a reservoir.	
<p data-bbox="94 1581 251 1608">Lake Mathews</p>  A 3D rendering of Lake Mathews, a large reservoir with a blue pipe running along its edge. The surrounding landscape is green and hilly.	

Weymouth Water Treatment Plant

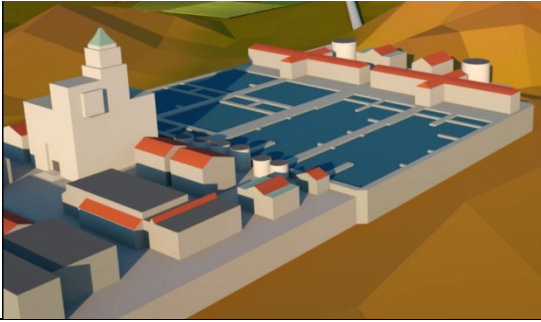

3. How is the water from the aqueduct used in Southern California? How many people rely on this water?

EXTRA CREDIT

The Colorado River is one source of water in Southern California. What are other sources of water?

How does water conservation help with our water supply in Southern California?